

The background of the cover is a photograph of a garden. In the foreground, there is a large agave plant with thick, pointed, blue-green leaves. Behind it, a spiky yucca plant with long, thin, yellow-green leaves radiating from a central point is visible. The background shows more garden foliage, including trees and a stone structure, possibly a fountain or sculpture, partially obscured by shadows.

INSIDE

THE GARDENS

SPRING 2023 A QUARTERLY MAGAZINE FOR
MEMBERS OF DENVER BOTANIC GARDENS



Chatfield Farms
rendering by Didier Design Studio

Gardens are all about change. Spring brings nature’s most dramatic moments as life seems to erupt anew. This season is one of the reasons visitors flock to see the parade of constant surprises.

And right now, some big changes are taking place, thanks to bond support from the citizens of Denver. Three areas on the south side of our York Street location are being re-envisioned. The Birds and Bees Walk will become a much-improved experience with a stunning boardwalk meandering through a specialized habitat, ending with a platform overlooking the Rock Alpine Garden. Not only will it be beautiful, but it will also make this unique habitat accessible.

The south side of June’s PlantAsia will transform into a Himalayan Garden, with a black stone outcrop and plants from the roof of the world. Again, accessibility is key. New walkways will make it easier to move through this rare collection. A stunning Tai Hu stone, donated by Robert and Lisa Kessler, will stand guard over the experience.

And wait until you see the new willow garden. Replacing what was South African Plaza will be a fitting Colorado transition from the conifer collection on the hillside to the Rock Alpine Garden to the west. Trickling water will intermingle with dozens of willow species. A new walkway will take you around and over a habitat that will attract pollinators of all kinds.

There will also be a new day dawning at Chatfield Farms. In early summer, we will break ground on the first phase of projects in the Master Development Plan. It begins with improved infrastructure, a stunning welcome center and the transformation of the old asphalt parking area into Market Square. On the south side of the site, expect to see a one-megawatt solar array that will incorporate agrivoltaics; our farm team will be growing vegetable rows in between the solar panels. This is a project in partnership with Xcel Energy, National Renewable Energy Laboratory (NREL) and the City and County of Denver. Twenty percent of the energy generated will be used to fully power Chatfield Farms and the rest will be used to offset energy costs for low-income housing.

Once again, I am awash in gratitude for donors, designers, builders, partners and the whole Gardens’ team for making dreams come true. After all, change, when combined with vision, becomes a spectacular future.

Onward.

Brian Vogt
Denver Botanic Gardens CEO

Contents

Featured Garden.....	2
Chatfield Farms.....	3
One World One Water Center.....	4-5
Education.....	6
Family Corner.....	7
Programs.....	8
Earth Day.....	9
Special Events.....	10-11
Trips & Travel.....	12
Plant Portrait.....	13
Research and Conservation.....	14-15
Volunteer	15
Exhibitions, Art and Learning Engagement.....	16-17
School of Botanical Art & Illustration.....	18
Tours.....	19
Trustees.....	19
Donor List.....	20
Tributes.....	21



INSIDE THE GARDENS

ISSUE 2, 2023

Denver Botanic Gardens

1007 York St., Denver, CO 80206

Pre-purchased tickets and advance member passes only.
Through May 13, 9 a.m. – 8 p.m., last admission 7 p.m.
May 14 – Sept. 4, 9 a.m. – 9 p.m., last admission 8 p.m.

Denver Botanic Gardens Chatfield Farms

8500 West Deer Creek Canyon Rd., Littleton, CO 80128

Pre-purchased tickets and advance member passes only.
9 a.m. – 5 p.m., last admission 4 p.m.

[Check the website for early closures](#)

General Information: 720-865-3500

Class Registration: 720-865-3580

Donations: 720-865-3528

Gift Shop: 720-865-3595

Membership Services: 720-865-3525

Private Events: 720-865-3551

Volunteering: 720-865-3609

Helen Fowler Library: 720-865-3570

Tours: 720-865-3539

Visit Our Website for More Information:

[Gardening Help from Colorado Master Gardeners](#)

[Kathryn Kalmbach Herbarium](#)

[Sam Mitchel Herbarium of Fungi](#)

Editor: Tiffany Coleman

Graphic Designer: Nick Elias

Photographer: Scott Dressel-Martin

The mission of Denver Botanic Gardens is to connect people with plants, especially plants from the Rocky Mountain region and similar regions around the world, providing delight and enlightenment to everyone.

DENVER BOTANIC
GARDENS

botanicgardens.org



The Gardens is grateful for funds from the Scientific & Cultural Facilities District (SCFD), which enable us to expand services and enhance the quality of our programs and exhibits.



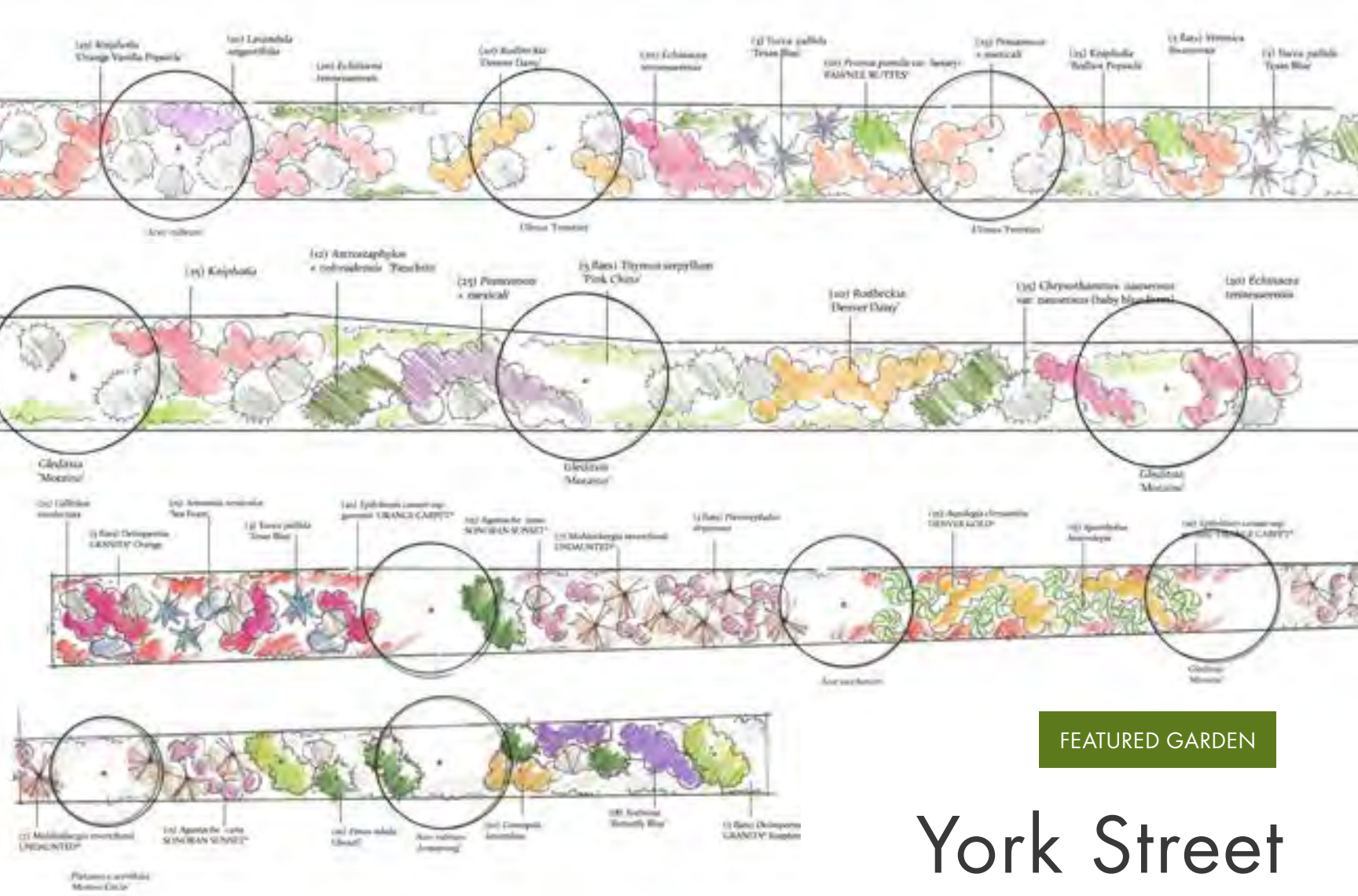

CHATFIELD FARMS

WATER CONSERVATION at Chatfield Farms

By Larry Vickerman, Director of Chatfield Farms

As the flows in the Colorado and Rio Grande Rivers continue to decline due to long-term aridification, water conservation is on everyone's mind. The adage "think globally, act locally" applies here. Conserving water at your point of use can increase availability in the entire watershed.

How do we reduce our water needs with a myriad of crops and gardens we grow at Chatfield Farms? We practice regenerative agriculture—a buzzword now—but we focus on managing soil for improved water retention and increased organic content, expanding composting programs, and incorporating cover cropping and pollinator zones.

We also have modified the way we deliver water to our crops by using an array of drip irrigation, high-efficiency sprinkler heads and low-pressure micro-sprays coupled with mulching, companion crops and minimum till practices. We have seen water savings as high as 30% compared to traditional sprinkler irrigation.

Watersheds and wetlands can also be improved through river and stream restoration. Increasing riparian vegetation and sinuosity in the channel will slow flowing water down, allowing it to sink into the surrounding ground for creek recharge after high water flows subside.

Chatfield Farms has implemented these methods with Deer Creek, which runs through our property. Restoration on the creek started six years ago with installation of beaver dam analogues (BDAs) that directed stream flow back into the old stream meanders, which had been cut off in the 1970s by channelization. The slowing down and redirection of flow has recharged the riparian groundwater and created a new flush of vegetative growth along the creek. In late season below the BDAs, Deer Creek flows about a month longer than it previously had because the recharged water table discharges water back into the stream when flows drop.

Much of the Deer Creek restoration work was funded by the Borgen Family Foundation. They have also generously contributed to the Chatfield Farms Master Development Plan to fund Market Square, a new event space adjacent to Deer Creek. Market Square is replacing a 60-car, asphalt parking lot with native trees, shrubs, grasses and flowers that will allow precipitation to sink in and help recharge the creek. The net result will be more and cleaner water in the creek system.

Through these methods, Chatfield Farms is conserving water for the long run.

FEATURED GARDEN

York Street TURF REPLACEMENT PROJECT

By Mario Bertelmann, Assistant Curator – Shade Gardens

Denver Botanic Gardens strives to be ever more sustainable and conserve our precious water resources. With the recent passing and approval of House Bill 22-1151, the Turf Replacement Program, new incentives will be available starting this year for Colorado residents, businesses and nonprofits to remove unused turf areas and replace them with more drought-tolerant landscapes that are appropriate for our semi-arid climate. In response to this, the Horticulture Department combined forces with the Gardens' staff Green Team to reimagine the turf areas along York Street and create a modern and innovative demonstration garden.

In March, we started removal of turf along the east side of York Street, which will be replaced with a stunning and drought-tolerant garden that will showcase the use of native and xeric perennials, ground covers and bulbs. This new feature will not only look

incredible as it formally greets visitors but will also reduce water consumption in the area by up to 100,000 gallons per year once it is fully established. In addition to conserving water, this project aims to inspire people to take on similar projects in their home and business landscapes to conserve valuable water resources while simultaneously enhancing aesthetics. The project will commence in early to mid-May. Plants will take a full season to fully establish, and the entire project will be documented using time-lapse cameras recording each step of the project. Signage will educate the public on the steps involved and the plants selected to create this new roadside display.

This exciting project is one of many that the Gardens is currently spearheading to make Colorado greener and protect our natural resources. Stay tuned to see this amazing transformation.

A River (Sometimes?) Runs Through It: RIVER CONNECTIONS

By Jennifer Riley-Chetwynd, Director of Marketing & Social Responsibility,
Co-Director of the One World One Water Center

It used to be that, outside the United States, people might know Colorado because of Coors Beer or the TV show “South Park.” Exported entertainment aside, being known for our beer was a good thing: after all, it was “brewed with pure Rocky Mountain spring water.”

Sadly, our water story has changed. Once the remains of murdered mobsters surfaced in the receding depths of Lake Mead this summer, the Colorado River’s

notoriety as North America’s most threatened river made global headlines. Severe and widespread drought last summer saw flows in European and Asian rivers hit record lows. More than 400 million people rely on the Yangtze River in China, which was so stressed it dried up in places. And in Italy, parts of its longest river (the Po) went dry, and the Tiber River that flows through Rome saw record-low flows as well.

Through the One World One Water Center (OWOW), a partnership with Metropolitan State University of Denver, the Gardens has built several **water-focused relationships with Italian entities** universities, water utilities, irrigation districts and several United Nations sustainable development entities headquartered in Rome. In November, the Gardens collaborated with these partners to organize a **one-day conference** in Rome on sharing best practices for water resiliency in the face of drought and climate change.

Larry Vickerman, director of Denver Botanic Gardens Chatfield Farms, and I both presented on horticultural and agricultural strategies to reduce strain on the Colorado River. Colorado was further represented by pre-recorded presentations from Denver Water’s CEO Jim Lochhead and Russ Sands from the Colorado Water Conservation Board.

The conference took place on November 24 – Thanksgiving in the U.S. Despite shared acknowledgment that drought is likely to become more severe, frequent and widespread globally, there were a

few silver linings to be grateful about. First, Italy was experiencing a very rainy fall. And, closer to home, there was hope that Colorado River users (seven U.S. states, tribes and Mexico) would heed the U.S. Federal Government’s recent mandate to figure out how to reduce withdrawals by 2-4 million acre feet annually (average annual flow in recent years is around 14 million acre feet). As of publication, that has yet to happen.

A wet winter in Colorado is of short-term help for the 40 million people in the Colorado River basin, but long-term challenges still loom. With this in mind, the Gardens is growing **our commitment** to share and jointly develop water management practices in horticulture and agriculture internationally, regionally and locally. The Colorado River, unlike South Park’s character Kenny (who dies and then magically re-appears in the next episode), may not have the ability to re-spawn.



Sustainability 101

By Lexi Cox,
School & Camp Coordinator

“What does sustainability mean?”

Hands raise with answers ranging from “conserving water” to “saving the planet.” This is my favorite way to start Chatfield Farms’ newest school program, Sustainability 101. It gives students a focus for the program and educators a sense of where the students are in understanding the subject.

Sustainability is minimizing what we are taking out of a system so there is access to resources in the future. While sustainability looks different in different systems, the goal is always the same—a healthier tomorrow for the very students visiting our farm. At Chatfield Farms, our focus revolves around regenerative agriculture practices. Our farmers are not only trying to conserve the ability to produce beautiful plants and nutritious food, but also to return this land to a healthy ecosystem.

Our biggest challenge is to avoid creating a sense of ecophobia as we teach. Otherwise known as eco-anxiety or eco-depression, ecophobia is a constant worry about environmental decay. Instead, we want to teach students that nature has incredible abilities without scaring them about the state of the Earth. This program allows kids to see firsthand how amazing nature is. From microscopic life in our soils, to the journey of a drop of water, nature is full of wonder if you know how to see it. That is what this program does—it shows students how to notice the complexities of life on the farm, or in their own neighborhoods, and how they can help to sustain it. And, when they are confronted with needing to heal nature, they are equipped with some ideas to make the task seem less daunting.



FAMILY
CORNER

Denver Botanic Gardens Celebrates Día del Niño

By Melissa Gula, Manager of Family and Children’s Programs

Día del Niño, or Children’s Day, is celebrated in Mexico on April 30. The day is filled with exciting festivities that expose children to culture, spur creative expression and highlight their importance in society. This April, the Gardens celebrates Día del Niño with stories and planting kits for children in the Helen Fowler Library. No admission ticket required for the following Día del Niño activities.

Nature Tales Family Story Time

Saturdays at 10:30 a.m.
throughout April

Bilingual Story Time, April 15
Hosted in partnership with Denver
Public Library.

Bring your budding naturalists to Nature Tales Family Story Time and discover the wonders of nature with your child. Together, we explore books that tell the stories of the natural world, of the garden and of our own backyard. Best for ages infant through 8, but all ages welcome.

Spring Planting Kits

Tuesdays – Sundays,
10 a.m. – 4 p.m.

Spring is the perfect time to start to think about planting seeds. In celebration of Día del Niño, you can take home a free children’s planting kit. Each kit includes the instructions (in both English and Spanish) and supplies you need to start some plants from seeds! Pick up kits at the Helen Fowler Library while supplies last.

Día del Niño Children’s Book Display

Our favorite children’s gardening books are displayed throughout the month of April for families to enjoy while visiting the library. Our selection of books includes titles in both English and Spanish. Stop by the library with your family to read some books and pick up your planting kit.

The Helen Fowler Library is located in the Freyer – Newman Center.
Hours: Tuesday – Sunday, 10 a.m. – 4 p.m.

FEATURED ADULT PROGRAMS

How to Grow the Best Dahlias on Your Block

Thursday, April 20, 9:30-11 a.m. | \$36, \$30 member

Join Horticulturist Jennifer Miller as she explores the wonderful world of dahlias and reveals how to grow dahlias like a pro. Get inside tips for growing and maintaining dahlias and digging and storing tubers.

A New Gardener Boot Camp ONLINE

Saturday, April 22, 10 a.m.: **Content opens**
Saturday, April 29, 10-11:30 a.m.: **Live Q & A**
\$46, \$42 member

Get started on the right foot this year with all our best beginner classes, carefully designed to equip you with all the tools you need to master that garden once and for all!

Spring Plant Sale Pregame Class

May 6, 10 a.m. | \$35, \$30 member

Discover the best practices for garden planning and choosing the right plant for the right place. Learn to create a cohesive, thoughtful garden that is also resource-conscious and friendly to wildlife and pollinators.

Guided Meditation Series at Chatfield Farms

Wednesdays, May 17 – July 5, 10-11 a.m.
\$18, \$15 member

Join us each week for a new intention and walk around the property at Chatfield Farms.

Schools and Teachers

Mark your calendars! This year registration for fall school programs opens in May. If you are interested in booking an onsite or outreach program during the months of September through December, check our [Schools & Teachers webpage](#) for updates and registration information or [sign up for our e-newsletter](#) for to stay looped in.





EARTH DAY





APRIL 22

Visit us at York Street or Chatfield Farms for a variety of free programming focused on our planet. A sample of activities and programming at each location is listed below. Admission to both sites is free this day.

York Street



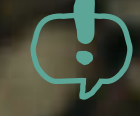



10 a.m. – 4 p.m.

-  **City of Denver** Stormwater Education and Phosphorus-free lawn fertilizer
-  **Xcel Tiny House**
-  **One World One Water Center (OWOW) and MSU Denver**
-  **Antiquity Clothing ReUse Booth**
-  Drop-in herbarium and Sensory Garden **tours, docents** in the galleries and **Science Learning Cart**

-  **Science Chats** in English and Spanish
-  **Film screening** in Sturm Family Auditorium
-  **Staff-led talk** on drought-resistant lawns, seed bomb and bug hotel demo, vericompositing, plant mapping station
-  **Children's programs:** Be a Botanist and Project BudBurst
-  **Botanicycle**, the Helen Fowler Library bike bookmobile

Chatfield Farms

10 a.m. – 2 p.m.

-  **What Is Regenerative Farming**
-  **The Life of a Single Water Drop**
-  **Why Is a Wetland Important?**
-  **Building a Bug Hotel**
-  **One World One Water Center (OWOW) and MSU Denver**
-  **Enter a drawing to win a prize!**

-  **Tracks & Scat**
-  **Compost talks**
-  **Colorado School of Mines** students talk regenerative farming projects
-  **Water-smart plants station**—inspiration for turf replacement

SPECIAL EVENTS

Get details on our [Special Events webpage](#).



SPRING Plant Sale

May 12 & 13, 9 a.m. – 5 p.m.
8-9 a.m., Member-only shopping hour

Admission is free, reservations are required

Join us as the Gardens transforms into a **one-of-a-kind plant sale!** Find unique offerings, expert advice and a variety of plants across 15 different divisions. Particularly special is our selection of native, steppe and other adapted plants that will thrive in Colorado's climate and soil. Members save 10% on all purchases. Get details and reservations online.

Spring Plant Sale Preview Party
May 11, 4-7:30 p.m. | \$55 advance, \$60 at the door (if available)

Don't miss our early access Preview Party! Enjoy first pick of plants and tasty treats & beverages.



DENVER BOTANIC GARDENS
CHATFIELD FARMS

LAVENDER FESTIVAL

July 15 & 16, 9 a.m. – 4 p.m.
\$7-\$13, must purchase tickets in advance

Chatfield Farms' Lavender Garden, with more than 2,000 lavender plants in peak bloom, sets the scene for this annual festival. Vendors sell all types of lavender-themed products from lotions and soaps to edible delights and wearable goods. Enjoy live music throughout the two-day event, plus demonstrations and classes. Chat with our gardeners and farmers. There are even activities for kids—so there's truly something for everyone. Be sure to get your tickets early! Tickets must be purchased in advance and are limited. Get tickets online.

Ticket on-sale dates:

Wed, May 17 Gardens Plus – President's Circle
Thu, May 18 Friends & Family
Fri, May 19 Dual Plus – Individual Plus
Mon, May 22 Public

MUSIC

AT THE GARDENS Presented by UMB Bank

Music at the Gardens returns this summer with two ways to experience live performances.

SUMMER & EVENINGS

CONCERT SERIES AL FRESCO

FEATURING

Rising Appalachia
JUNE 26

Santigold
JULY 6

Esperanza Spalding
JULY 11

Preservation Hall Jazz Band
JULY 24

Ozomatli
AUGUST 9

AND MORE!

The Summer Concert Series offers a traditional stage show with world-famous musicians performing in the UMB Bank Amphitheater. Enjoy a picnic on the lawn or a leisurely stroll through our gardens as you listen to top recording artists. Get tickets and full lineup at concerts.botanicgardens.org



Select Mondays & Wednesdays,
June – August, 4:30-8:30 p.m.

Evenings al Fresco offers a serene listening experience with local artists performing throughout the Gardens. Visitors are welcome to explore at their own pace, discovering local talent along the way. [Get tickets online.](#)

PRESENTING SPONSOR

UMB
BANK

TRIPS & TRAVEL

Travel the world with Denver Botanic Gardens. Get full details about all trips on our [Trips & Travel webpage](#).

Medellín, Colombia: Festival of Flowers (Feria de Flores)

August 6-13

Experience the intoxicating Festival of Flowers, *Feria de las Flores*, in Medellín, Colombia. This event celebrates the city's cultural heritage with parades, live music, dances, competitions and exhibitions of flowers and plants. One of the highlights of the festival is the "Desfile de Silleteros," a parade of colorful flower arrangements carried through the streets on the backs of local farmers.

Cape of South Africa

September 23 – October 8

Explore the magnificent landscapes of the western Cape of South Africa, a botanical holy grail. With an exceptional level of biodiversity, this is the richest of the world's five Mediterranean climate regions in terms of species per square kilometer. Led by Denver Botanic Gardens' Director of Horticulture Phillip Douglas, this 15-day tour includes visits to Scarborough, Redhill, the Tienie Versveld Reserve, Paarl Mountain and Kirstenbosch Botanic Gardens.

Magical Mexico: Oaxaca

December 2023

See Oaxaca through the lens of art and cuisine. Known for its vibrant mestizo heritage, rich artisan culture and smoky mezcal, this is one of Mexico's most interesting states.

Botanic Wonders of Ecuador

January 2024

Ecuador is home to more than 10% of the world's plant species. This eight-day trip hosted by Panayoti Kelaidis showcases the country's staggering flora. Visit a variety of habitats from the Andean Highlands and Cotopaxi Volcano to lush rainforest and cloud forest reserves. Enjoy Quito's historic center, Quito Botanical Gardens and a rose production facility.

Magical Mexico: Monarch Butterflies, Mexico City and Valle de Bravo

February 5-11, 2024

Every winter, montane cloud forests in central Mexico host millions of over-wintering monarch butterflies, creating one of the most impressive wildlife spectacles on the planet. Spend two days at monarch butterfly sanctuaries. Then, explore vibrant Mexico City, known for its thriving art scene, charming neighborhoods, world-class gastronomy and unique blend of old and new.

PLANT PORTRAIT

JAMESBRITTENIA

By Mike Bone, Associate Director & Curator of Steppe Collection

Jamesbrittenia; it's really the cat's meow.

Jamesbrittenia is a genus of plants with a wide native distribution, occurring from Zambia all the way down to the cape of Southern Africa. Some species can be found in Sudan, Egypt and even parts of India. This beautiful group of plants is part of the Scrophulariaceae (figwort or snapdragon) family. The species range from small, flat ground covers to shrubs over a meter tall and can be found in a variety of habitats, including steppe environments similar to Colorado.

Several species of *Jamesbrittenia* can be found growing in the Steppe Garden, while in the greenhouses staff are actively working on hybridizing this genus to create new and exciting cultivars for introduction to the horticultural community.

The name comes from English botanist James Britten. James was a junior assistant in the herbarium at the Royal Botanic Gardens, Kew, but spent most of his career in the botany department at the British Museum during the late 19th/early 20th centuries. He was known for being an excellent editor of botanical scripts, if not cantankerous at times.

Recently, the Gardens partnered with Denver Cat Company to adopt a working cat for the production greenhouses at Chatfield Farms. Denver Cat Company had the perfect feline to help our team, one who showed excellent promise but was a little cantankerous with the other residents. This newest member of the Chatfield Farms greenhouse crew has been named *Jamesbrittenia* (or James, for short) both for his sassy attitude but also, like the plant, his many other wonderful attributes. We welcome *Jamesbrittenia* to our team.



Photos by Mike Bone



Shaping Water Conservation Through GREEN STORMWATER INFRASTRUCTURE

By Christina Alba, Ph.D., Assistant Research Scientist

The ecological processes that shape plant communities are often viewed as being “top down” or “bottom up.” For example, herbivores can influence plant size by exerting pressure from the top down. In contrast, soils regulate plants from the bottom up by providing resources plants need to grow. As we grapple with societal challenges like increasing water scarcity, we must also act from all directions, including top down (national and world governments) and bottom up (individuals and local groups). The levers of top-down progress may often feel out of reach—so it can be exciting and inspiring to witness meaningful, local change.

One such example is the nascent green stormwater infrastructure (GSI) project happening along the High Line Canal near Denver. As less water enters the canal from its headgate in Waterton Canyon, new infrastructure will capitalize on rain events by directing stormwater into the canal. This stormwater will be held in place for up to 72 hours, allowing time for it to “slow, spread and sink” into the canal bed and banks. The planned GSI will support the canal’s unique ecological function, as over the past 140 years, water-loving shrubs and trees have established a shady, urban forest in what would otherwise be semi-arid grassland.

How the new GSI functions will literally be shaped from the bottom up, as the plants and soils that characterize the canal will impact water infiltration rates and which pollutants might be scrubbed from incoming stormwater. Research by Gardens scientists has shown that soils where GSI has been implemented is healthy – for example, it has ample



pore space for water infiltration and plenty of soil organic matter for maintaining soil structure and retaining plant nutrients. There are also lush pockets of wetland species dotting the canal bed, including the native sedge, *Carex emoryi*. Sedges are often planted in GSI settings to aid in pollutant removal and stabilize soil, making this naturally occurring sedge not only a verdant beauty, but a likely workhorse in supporting the GSI’s ecological function.

Given that the canal meanders through 11 jurisdictions, it would be remiss to ignore the critical bottom-up element that is the people who care for this ecological gem. With guidance from the High Line Canal Conservancy, multiple stakeholders have been working to create a management plan for the canal’s evolving future – one that keeps more than 350,000 people connected to the soil, plants and animals that depend on this unique urban waterway.

VOLUNTEERS

Ongoing Volunteers Needed

The Volunteer Services Department is gearing up for a busy spring season – a perfect time to join us as an ongoing volunteer! There are a great number of ways you can help support various departments and the operations of the Gardens working alongside our staff.

If you are interested in joining our ongoing volunteer program, please submit a [New Volunteer Interest Form](#) and our team will be in touch to guide you through the onboarding step requirements. You can also get more info at botanicgardens.org/volunteer. Have questions? Contact the Volunteer Services Department at vol@botanicgardens.org or 720-865-3609.

ART & EXHIBITIONS



Melanie Yazzie: Peace Walking

Through May 29

Encounter wonder and healing with Melanie Yazzie's colorful prints, paintings and sculptures. Yazzie layers nature and narrative to tell a story both personal and communal, drawing partly from her Diné (Navajo) heritage.

Melanie Yazzie, *Two Sisters*, acrylic and mixed media, 2022.



Renewal: Sculptures by Tamara Kostianovsky

Through June 18

Repurposing fabrics to build textile sculptures of tree stumps and tropical birds with flora, Tamara Kostianovsky's works weave together a narrative about loss and the power of hope.

Tamara Kostianovsky, *Becoming Native*, discarded textiles on wood, 2022.



2023 Land Line Resident Artists

Meet the 2023 Land Line residents, artists working in a variety of media to explore humanity's unique connections to nature.

Kiki Gaffney, *Vestige*, acrylic, graphite, colored pencil and gold leaf, 2022.

Justin Favela: Vistas in Color

June 11 – Oct. 1

Vibrant and immersive, *Vistas in Color* honors the sweeping desert landscapes of the U.S. and Mexico and the role that they've played in Latinx identity.. Favela's floor-to-ceiling piñata-paper murals are tribute to the landscapes that make us who we are.

Justin Favela, *Popocatepetl e Iztaccihuatl vistos desde Atlixco, after José María Velasco*, paper, glue and cardboard, 2015. Photo: Mikayla Whitmore.



Ansel Adams: Early Works

June 11 – Oct. 1

Discover the early work of renowned landscape photographer Ansel Adams in this exhibition of intimate yet majestic photos of the American West. Featuring many of Adams' finest photographs of Yosemite National Park and other Western landscapes.

Ansel Adams, *Clearing Winter Storm, Yosemite National Park, California*, gelatin silver print, 1940. Center for Creative Photography, Ansel Adams Archive © The Ansel Adams Publishing Rights Trust.



SCHOOL OF BOTANICAL ART & ILLUSTRATION

Creative Convenings

April 20 and June 23, 5 p.m.

Free; advanced registration required

Artists, scientists, dancers, cooks, gardeners—all are welcome! Bring your gently used tools and supplies and contribute to a supply swap. During this free informal gathering, meet with fellow creatives and celebrate the fusion of science and art.

Food for Thought

April 7, May 5 & June 2

Free; advanced registration required

Seeking advice about how to take your creative practice to the next level? This new online series addresses professional practices in the art world and shares skills that will help our creative community thrive.

Sketching in the Galleries

Select Sundays | \$18, \$15 member

Join us on select Sunday afternoons in the art galleries of the Freyer – Newman Center to practice your observational skills and draw amid the art. Bring your favorite dry pencils, paper, and an open mind.

Intersections: Conversations on Art & Science

April 12, May 10 & June 14 | \$12, \$10 member

Join invited artists, scientists, community members and thought leaders as they cover a wide range of topics that highlight the junctions of art and science. This spring: Kalliopi Monoyios, Tyler Thrasher, Erin E. Hunter.



Tyler Thrasher, photo provided by artist.

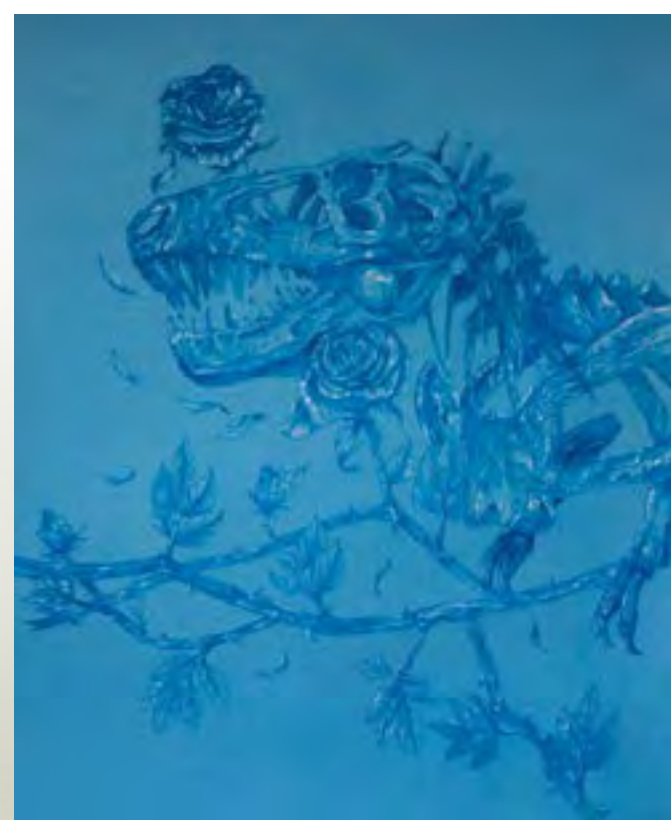

Tyler Thrasher, *Tyrannosaurus Rex*, blue mechanical pencil with charcoal drawn on hand dyed and hand made blue paper, 2022.

TOURS

Explore our gardens or galleries with a knowledgeable guide any time of year to gain fresh insight and inspiration! For more information or to register, visit the [tours page](#) on our website or contact tours@botanicgardens.org.

YORK STREET

DROP-IN TOURS

Included with admission

Garden Highlights Tours

Select Fridays – Sundays (and Monday holidays) at 11 a.m. & noon

Herbaria Tours

Select Fridays, 10 a.m. & 11 a.m.

Guided Introduction to the Gardens in Spanish

Visita guiada de introducción a los Jardines en español
Select Fridays, 10 a.m. & 11 a.m.
Viernes selectos a 10 a.m. & 11 a.m.

STAFF-LED TOURS

\$10 member | \$20 non-member | \$5 student

Curator Conversations

April 20 at 10 a.m.
May 18 at 10 a.m.

Expert Explorations

April 15 at 2 p.m.
Learning engagement coordinator and Nerdy Naturalist Vanessa Callahan examines early budding trees, grasses and flowers throughout the gardens.

DOCENT-LED TOURS

\$8 member | \$16 non-member | \$5 student

Seasonal Discoveries

April 16 at 2 p.m.
May 14, 27 at 2 p.m. & May 28 at 10 a.m.
June 3 at 10 a.m. & June 10, 25 at 2 p.m.

Exploring Exhibitions

April 23 at 2 p.m.
May 6 at 10 a.m. & May 20 at 2 p.m.

At Home with Your Houseplant

April 15 at 10 a.m.
May 20 at 10 a.m.
June 24 at 10 a.m.

Nature Inspired Design

May 21 at 10 a.m.
June 4 at 10 a.m.

A Walk Through Thyme

June 4 at 6 p.m. & June 11 at 10 a.m.

Connect & Learn!

Join us on Earth Day, Saturday April 22, for free drop-in tours of the gardens, galleries and herbaria every hour from 10 a.m. to 4 p.m. plus tours en Espanol at 11 a.m. & noon. Meet in Boettcher Memorial Center lobby. No registration required. See page 9 for more information.

CHATFIELD FARMS

DROP-IN TOURS

Included with admission

Garden Highlights Tours

Select Saturdays & Sundays at 10 a.m. & 11 a.m.

DOCENT-LED TOURS

\$6 member | \$12 non-member | \$5 student

Seasonal Discoveries

April 15 at 10 a.m.
May 14 at 2 p.m.
June 3 at 2 p.m. & June 18 at 10 a.m.

STAFF-LED TOURS

\$8 member | \$16 non-member | \$5 student

Expert Explorations

June 18 at 11 a.m.
Engage your sense of smell as we visit many of the cultivated gardens at Chatfield Farms with Emily McAuley, horticulturist of greenhouse production.

PLAINS CONSERVATION CENTER

For more information, call 720-739-0870 or contact pccinfo@botanicgardens.org.

MOUNT GOLIATH

Free drop-in tours at the Dos Chapelle Nature Center are expected to start mid-June, weather permitting. Please [check online](#) for current information and [reserve tickets in advance](#).

PRIVATE TOURS AT YORK STREET OR CHATFIELD FARMS

Looking for a customized experience for your group of six or more? Schedule a private guided tour. For more information, contact tours@botanicgardens.org or [complete our form](#).

2023 Board of Trustees

OFFICERS

Mr. Mike Imhoff, Board Chair
Ms. Mary Lee Chin,
Vice Chair
Ms. Dawn Bookhardt,
Secretary
Mr. Abe Rodriguez, Treasurer
Ms. Kathy Hodgson,
Immediate Past Chair

TERM TRUSTEES

Ms. Diane Barrett
Rabbi Joe Black
Mr. Jose Carredano
Dr. Clint Carroll
Mr. Andrew Cullen
Mr. Papa M. Dia
Ms. Melissa Eliot
Sen. Rhonda Fields
Ms. Veronica Figoli
Ms. Cory Freyer
Ms. Kathy Hodgson
Dr. Dorothy Horrell
Ms. Ding Wen Hsu
Mr. Mike Imhoff
Mr. Christopher Leach
Ms. Wy Livingston
Mr. Ron Otsuka
Ms. Yrma Rico
Mr. Abe Rodriguez
Mr. Brad Stevinson
Ms. Marianne Sulser

MAYORAL TRUSTEES

Ms. Nina Casanova
Ms. Tiffany Herrick
Mr. Eliot Hoyt
Ms. Caroline Schomp

LIFE TRUSTEES

Mrs. Thomas E. Taplin

TRUSTEES EMERITI

Dr. Jandel Allen-Davis
Ms. Dawn Bookhardt
Ms. Mary Lee Chin
Mr. Richard Clark
Mrs. Judi Newman
Mr. Scott Richards
Mr. Harold Smethills

EX-OFFICIO TRUSTEES

Ms. Christina Caulkins,
President, Denver Botanic
Gardens Endowment, Inc.
Mrs. Suzanne Coxhead,
Denver Debutante Ball
Ms. Happy Haynes,
Denver Parks & Recreation
Ms. Kitty Rapalyea,
President, Denver Botanic
Gardens Guild
Ms. Cynthia Scott, President,
Garden Club of Denver

Donors of Distinction

Gifts Received November 1, 2022 – January 31, 2023

Citizens of the Scientific & Cultural Facilities District
Anonymous
Ms. Lorraine Adams and Ms. Deborah Horner
Rebecca Adams
Katherine Aertker
Mona Ahmed
Alpenglow Foundation
American Online Giving Foundation
Andrew and Erin Anderson
Balin Anderson and Nilesch Parikh
Gail Anderson and Barbara Edwards
Applewood Seed Company
Armanino
Liz Armstrong
Mr. Hartman Axley
Eugene H. Baber II and Gale Johnson
Julie Bachman
Dennis Baldwin
Bank of America
Barbara & Victor Klein Family Charitable Fund
Mrs. Laura Barton and Mr. William Matthews
Beanstalk Foundation
Kim N. Benson and Allen Staver
Scott Benson
Alison and Thomas Betts
Julie and Michael Bock
Boettcher Foundation
Barbara Bohlman
Botanical Interests, Inc.
Mary Bradley
Britina Design Group
Dona and Stanley Brown
Marilyn Brown
Mr. and Mrs. James Burdick
Mrs. Cameron Burn
Frances Burton
Jim and Sharon Butler
Kathleen and Bruce Butterfield
Carole and William Buyers
Frank and Jen Callahan
Susan Carr
Katherine Casey and Jon Taylor
Lee Ann Cast
Mr. and Mrs. George Caulkins II
Caulkins Family Foundation
Central Carolina Community Foundation
CenturyLink
Charles H. Kurtz Family Foundation
Jan W. Chase
The Chill Foundation
Holly McDonald
Dee Chirafisi
Mr. and Mrs. Bruce Clinton
The Clinton Family Fund
Brodie Cobb and Elizabeth Ohm
Colorado Center for Reproductive Medicine
Combined Jewish Philanthropies
Barbara & Victor Klein Charitable Fund
Community First Foundation
Ann and Jac Connelly
G. K. and Virginia Conwick
Mr. William Cook and Mrs. Nancy Cook
Frances Corsello
Robert Couri
Thomas and Suzanne Coxhead

Martha Davis
Davis Graham & Stubbs, LLP
DBC Irrigation Supply
Dr. Robert Dellavalle and Dr. Lisa Schilling
The Denver Foundation
Grogan Family Fund
Hamlin Family Fund
Monica and John Geocaris Fund
Thomas and Beatrice Taplin Fund
Thomas P. Owen Family Fund
Walter C. Emery Family Foundation Fund
Marguerite and Tom Detmer
Catherine Dews Edwards and Philip Edwards
Mr. and Mrs. Charles L. Dibble
Central Carolina Community Foundation
Dibble Family Fund
Joy and Chris Dinsdale
Ben Dukes and Mary Dukes
Mr. Peter D. Durst, C.H. and Ms. Ellen Seale
Robert Dyer
E2 Optics
Echter's Nursery & Garden Center
El Pomar Foundation
Eleanor and Henry Hitchcock Charitable Foundation
Elevated Third
Energy Resources LLC
Victoria and Stephen Eppler
Estate of Alma J. Ryan
Estate of Charles B. Smith
Factor Design Build
Teresa and Kelly Ferguson
Fidelity Brokerage Services
Fidelity Charitable Gift Fund
Ben Garnett Charitable Fund
Hollis Family Fund
Jane Nagel Charitable Foundation
My Choice
Nagel Family Fund
Shaw Charitable Trust
Valerie and Nicki Finberg
John and Sarah Finn
Ms. Tamara Fischer and Mr. Jeff Kellogg
Ms. Mary D. Fowler
Sonia Franzel and David Franzel
Ms. Cory Freyer
Mr. and Mrs. John E. Freyer
Mr. and Mrs. Robert K. Fuller
Shannon Garcia Lewis and Barbara Garcia
Ben Garnett
Caleb and Sidney Gates
Monica Geocaris
George J. & Elizabeth Park
Robinson Trust
GH Phipps Construction Companies
Pat Giarritano and Janina Kozacka
Mrs. Sissy Gibson
The Gilman Family Foundation
Scott Gilmer
Dr. Alan Glickman and Nanette Santoro
Linda Good Wilson and Mark A. Wilson
William Gorsky
Newell Grant
Richard Grisinger
Barbara Grogan

HALCYON, a hotel in Cherry Creek
Tom Haller
Mrs. Mary Ann Hamilton Lamont
Linda E. Hamlin
Catherine Hance
Dan Hancock
Jenna Harris and Dillon Teske
Amy Hart
Karin and Kent Harvey
Susan and Michael Hawes
F. B. Hebert
Richard Hess, Jr. and Alison R. Hess
Connie Higgins
Doug and Kathy Hodgson
Ms. Susan McLoon Hodson
Mr. and Mrs. Graham E. Hollis
Honnen Equipment Company
Amanda Howard and Brian Damman
Hubbard Family Foundation
Patricia and Gregory Hueni
Kathryn Huwaldt
Mr. and Mrs. Michael Imhoff
Teresa Ish
Dr. Stephen J. Jacobs and Ms. Catherine Lane
Jacquard Hotel & Rooftop
Diane and Larry Jensen
K'Lynne Johnson
Mr. Jack R. Jones
Karen Jones
Mr. Donald J. Kany and Mrs. Susan C. Kany
Karen J. Glanert Charitable Trust
Tara Kilroy
Kevin and Dorota Kilstrom
Jonathan Klingel
Carol Knight
Mark and Jolly Krautmann
Peter J. Kirsch and Pat Reynolds
Mr. and Mrs. Frank A. Kugeler
Mr. and Mrs. Charles H. Kurtz
Lori and Bill Kurtz
Mr. and Mrs. Jerry D. Ladd
Land Title Guarantee Company
Mary Larson
Christopher K. M. Leach and Chad Skrbina
Jessica Levhofer
Karen E. Lochbaum and Thomas Shallow
Kathleen and Rick Lofgren
Daniel Lyons and Laura Zerbe
Mr. and Mrs. Robert L. Manning, Jr.
Marguerite and Max Martin
Sharon and J. Landis Martin
Terry Mather
Dr. William Mauldin and Margie Mauldin
Mr. John Mayer and Mrs. Barbara Mayer
Amy and John McCready
Mrs. Eileen Honnen McDonald
and Mr. Ed McDonald
Ms. Katherine Meier and Mr. Steven Meier
The Louis R. & Dorothy M. Meister Foundation
Melville Foundation
Joanne Meras
Mile High United Way
Gene and Dee Milstein
Ronald and Bonnie Milzer
Megan Mistler and Scott Chrisbacher
Mrs. John C. Mitchell, III

Kalliopi Monoyios
Marie and James Monroe
Mr. and Mrs. John Morrison
Ms. Kim Morss and Mr. Richard Dehncke
Kiyoko Mura-Smith and John A Ware
Jane and Robert Nagel
National Philanthropic Trust
Barbie and Tony Mayer Charitable Fund
Bock Family Fund
The Karen E. Pfeifer Charitable Gift Fund
Robert and Judi Newman
Mr. Peter Nielsen
Oak Park River Forest Community Foundation
Kovacs Family Fund
Colleen A. O'Connor and Matthew Mcelhiney
Martin J. & Mary Anne O'Fallon Trust
OpenTable Colorado
Oppenheimer & Co. Inc
David E Oswald and Laurie Sankey
Ronald Otsuka
Mr. and Mrs. Thomas P. Owen
Pacific Premier Trust
Lorraine Parker and Elizabeth Starrs
Paul and Meredith Kay Passmore
Daniel Paulien
Jennifer Peters
Emi and Dan Peterson
Harriet Peterson
Elizabeth Peyton
Karen E. Pfeifer
Ms. Alita Pirkopf
Carol Knight
Andrea Pollack
Kathleen and Jim Potter
Marcie and Koger Propst
Jeanette Pryor
Mr. Gary B. Randall
RBC Wealth Management
Joanne E. Reilly and Ronald T. Otsuki
Ms. Cynthia P. Reiners
Kathleen and Dustin Rhodes
Robert and Myra Rich
Richard and Diana Vigil Charitable Trust
Scott Richards and Terrie Fontenot
Jeanne O. Robb
Nicole Roberts
Mr. and Mrs. Gerald B. Ross
Gregory Ross and Brad Wellens
Dennis and Cee Cee Roundtree
Margie Sanderson
Satoyama Bonsai SavATree
Jonathan Schmitz
Diane and William Schneider
Catherine Schoelzel
Taylor Schollmaier and Kimberly Schollmaier
Mr. and Mrs. Barney Schotters
Gail Schraishuhn
Charles Schultz
Schwab Charitable Fund
Claudia Brown
Jensen Family Charitable Fund
Sullivan Family Charitable Fund
The Martha Davis & Richard Sayers Family Fund
The Sam & Beth Coyle Family

Charitable Fund
The Schollmaier Family Fund
Judith Seaborn
Ms. Ashley Cole Seidman
Judy Sellers
Shelley Sendelbach
Benjamin Shaw
Patti Shwayder-Coffin and Steve Coffin
Stan Siefer
Mo Siegel
Singer Family Foundation, Inc.
Mr. and Mrs. Thomas J. Sisk, Jr.
Julia E. Smith
Shelley Smith
Ruth and Brian Spano
Connie Sprovieri
Kathryn Spuhler
MaryAnn Stabio and Debbie Fitzgerald
Mrs. John H. Stamper
Colleen Stein
Sturm Family Foundation
Edna and Chuck Sullivan
Kenneth N. Swartz and Pamela Simko
Ean Tafoya
Mrs. Thomas E. Taplin
TCI Wealth Advisors
Joey Terriquez
The Art Of Concrete
The MacMeier Foundation
The Marcus Foundation
The Vineyard Wineshop
Jim Theye and Dee Chirafisi
Tigris Sponsorship and Marketing
Mr. Victor Timmons
Judi and Bryan Tointon
Ann Torgerson
Aimee Trechock-Peters and Dr. Wayne Peters
Two Octobers
Fotios Tzellos
Donna and Henry Unger
Mark Valerio
Vanguard Charitable
The Caldwell Stair Charitable Fund
The Donald and Harriet Peterson Charitable Fund
Mr. Brian R. Vogt
Kyle and Jennifer Walsleben
WCR/Economy Data Foundation
Ira Wertenteil and Cindy Powders
John Westcott
Suellen and Travis White
Michelle and Tom Whitten
Gwen Sanderson
Dr. John L. Wilberg
Joanna and Aaron Widmann
Marjorie Widmann
Wild Heritage Gardens and Design, LTD
Norman and Joan Wilson
Stefanie and Patrick Winfield
The Winthrop Foundation
Kenneth and Janet Wolfram
Dawn Wood
Mr. and Mrs. Charles H. Woolley II
Xcel Energy
Mr. and Mrs. Robert Zapanarick
Wallace Zellmer
Ms. Linda R. Zinn

Honor/Memorial Contributors

Gifts Received November 1, 2022 – January 31, 2023

IN MEMORY

In memory of Marcia Aberle
Craig Aberle
Aberle Family Fund
Honor/Memorial Contributors

In memory of Bruce and Chick Alexander
Rebecca Safarik and Roger DeWitt

In memory of Dean Bartell
Mary Ann Ross

In memory of Marie C. Baumann
Jack Montgomery

In memory of Jacques Benedict and Ursula Benedict McPhee
Michael B. McPhee

In memory of Rachel T Billing
Heather Munoz

In memory of Jacqueline Blue Hayes
Deborah J. Blue

In memory of Sue Boelter
Amanda Shindledecker

In memory of Joseph Bozzuto
Carol Bellemore
Carol and Anthony Creto
James and Nancy Mathewson
Maryjane O'Neill and Thomas O'Neill
William and Barbara Simione
Sandra and Gerald Wischmeyer

In memory of Victoria Calomino
Javier and Ashlee Cespedes

In memory of Jean Cole
Ms. Ashley Cole Seidman

In memory of Edward P. Connors
Jim R. Arneill
Joel Bedford
Catherine and Steve Begej
Margaret F. Brown
Central Carolina Community Foundation
Ethel S Chapin and Edward W Chapin
Hope B. Connors
Jane and Tim Davis
Martha Davis
Mr. and Mrs. Charles L. Dibble
Dibble Family Fund
Edwin Fenwick Charitable Trust
Mary Elghandour
Mr. Bayard Ewing and Ms. Pauline Green
Mr. Edwin A. Fenwick
Ms. Cory Freyer
Mrs. Mary Ann Hamilton Lamont
Sheilagh Hudon and William R. Hudon
Martin J. & Mary Anne O'Fallon Trust
Mrs. Barbara M. Rumsey
Alan K Simpson and Ann S Simpson
The Martha Davis & Richard Sayers Family Fund

In memory of Colleen Elizabeth John
Jack Grosz

In memory of Ann Johnsen
Gloria Dietz

In memory of Cordie Kagahara
Barbara and Rick Fried
Margaret and John Hillman

In memory of Lynn Kilroy
Tara Kilroy

In memory of Claire Kuhns
R.D. Kuhns

In memory of Sandy Lutz
Deborah Lutz

In memory of Sid Malmberg
Ms. Gretchen Pate and Mr. Tom Hail

In memory of Anne Mather
Terry Mather

In memory of Mom and Dad
Jon Schutz

In memory of Eva O Dyer
Robert Dyer

In memory of Marilyn Shaw
John J. Craighead
Ms. Meg Johnson and Mr. Gene Lang
Benjamin Shaw

In memory of Suzi Fogarty
Judy Rough

In memory of Anna R. Garrey
Morse Family Foundation
In memory of Mike Gellner
Claudia Schwartz

In memory of Erin Michelle Gilmer
Scott Gilmer

In memory of Marilyn Girouard
Carol Knight

In memory of Seth Goldstein
Marjorie Goldstein
Elizabeth Read

In memory of Barbara Grebe
Elderlink Home Care, Inc.
Jennier Grebe
Karen Moorehead
Mark and Cecily Vigil

In memory of Donald Haldi
Mr. and Mrs. Robert Zapanarick

In memory of Keith Hammond
Mrs. Becky Hammond

In memory of Richard "Dick" Harrison
Olin L. Webb

In memory of Janet Laura Hodgson
Doug and Kathy Hodgson

In memory of Rita Hohman
Eda DiPasquale

In memory of Marnie Honnen
Mrs. Eileen Honnen McDonald
and Mr. Ed McDonald

In memory of Connie Hyde
Ms. Patricia Gage and Mr. Rob Holway
Wayne and Cheryl Rickert

In memory of Colleen Elizabeth John
Jack Grosz

In memory of Ann Johnsen
Gloria Dietz

In memory of Cordie Kagahara
Barbara and Rick Fried
Margaret and John Hillman

In memory of Lynn Kilroy
Tara Kilroy

In memory of Claire Kuhns
R.D. Kuhns

In memory of Sandy Lutz
Deborah Lutz

In memory of Sid Malmberg
Ms. Gretchen Pate and Mr. Tom Hail

In memory of Anne Mather
Terry Mather

In memory of Joann Mauro & her daughter Cathy
Frank J. Mauro

In memory of John C. "Jock" Mitchell, III
Mrs. John C. Mitchell, III
Mr. and Mrs. Stephen L. Waters

In memory of Quentin "Kim" Mitchell, Jr.
Mrs. John C. Mitchell, III
Mr. and Mrs. Stephen L. Waters

In memory of Ann Montague
Anonymous

In memory of Lula Mae Moravec
Diane L. Moravec Heidel

In memory of Bertha Moreno
Brenda Eisenhauer

In memory of Colleen O'Conner
William Turque

In memory of Ainslie O'Neil
Anonymous
Britina Design Group
Brock and Company, CPAs, P.C.

In memory of Robert Couri
Harry Freer
Mrs. Jennifer A. Heglin
Ken and Karen Heuer
Brian Johnston
Peter J. Kirsch and Pat Reynolds

In memory of Karen and Rich Leduc
Karen Masterson
Richard and Jean Reinhart
Anthony Sauls
Ms. Julia M. Shepherd
Alison Steiskal and Mark Pelz
Jasmine Vaghedi
Justin Wehler
Mr. and Mrs. Jamie E. Westcott
Jenette Whipp

In memory of Nancy Edmonds and John Hughes
Andrew L. Garza

In honor of Leslie and Howard Farkas
The Clinton Family Fund

In memory of Suzanne Price
Lisa and Rich Zavoda

In memory of Dr. Joe Richard
Dr. Jon Richard and Michael Filkoski

In memory of Anna L. Samuels
Mr. Arnold Samuels and Mrs. Karen Samuels Jones

In memory of Jonathan Sanderson
Gwen Sanderson

In memory of Caeleigh Shellhart
Anonymous

In memory of Lynn Stockton
Merilou Johnson and Dann Milne

In memory of Jacob B. Trumbower
Marvin Fisher

In memory of Louise Turnbull
Laura Turnbull

In memory of Arthur & En Watada
Tomiko Takeda

In memory of Andrea "Jodi" Westcott
John Westcott

In memory of Ed and Ann White
Dr. Andrew Sirotnak and Mr. Jamie Waring White

In memory of Linda White
Dr. Stephen J. Jacobs and Ms. Catherine Lane

In memory of George Linn Wilson
Jeanette Pryor

In memory of Carole Wolfe
Michele Wolfe and Laurie Best

In memory of Cynthia Zellmer
Wallace Zellmer

IN HONOR

In honor of Gail and Larry Bakko
Daniel Bakko and Yabo Sun

In honor of Barbara Bohlman
Mary E. Morrin

In honor of Mike Bone
Ms. Anita Cox

In honor of Beth Bonnicksen
Greyson Vurciaga

In honor of Phyllis Brown
Plumley Family

In honor of Mary Lee Chin
Marianne Smith Edge

In honor of Caitlin Craigie
Mr. John Sadwith and Ms. Karen Grote

In honor of Mary Earl
Lindsey Earl

In honor of Nancy Edmonds and John Hughes
Andrew L. Garza

In honor of Leslie and Howard Farkas
The Clinton Family Fund

In honor of Taliesin Finch Hollen
Ella Lara

In honor of Mary Fowler
Hilltop-Crestmoor Gardeners Garden Club

In honor of John and Ginny Freyer
Jim R. Arneill

In honor of Pam Giordano
Emily Klein

In honor of Catherine Hance
Maria Oxman

In honor of Diane Heasley
Diane Heasley

In honor of Lindsay Stolberg Heller
Beanstalk Foundation

In honor of Dan and Karen Hopper
Laurel Schaffer

In honor of Tia Hynes
Serena Bruzgo

In honor of Johanna Elizabeth Kelly
Mr. and Mrs. Robert K. Fuller

In honor of The Kinsey Family
Catherine Kinsey and Clinton Smullyan

In honor of Eric Komppa
Leon McBroom

In honor of Mary Lynne Lidstone
James Lidstone and Alaina Reilly

In honor of Nancy Lockwood
John Lockwood

In honor of Mike and Heather Miller
The Clinton Family Fund

In honor of Georganne Mitchell
Darlys Michaelis

In honor of Margaret Morse
Andrea Meier

In honor of Rutger Myers
Southern Gables Neighborhood Association

In honor of Helene Pfluger
Helen Kaupang

In honor of Philosophy Communication
Diane Amdur

In honor of Camille and Savannah Plumley
Phyllis and Jack Brown

In honor of Robert W. Price
Dyanne Russell

In honor of Elaine Renz
Robert Renz

In honor of Michael Sadwith
Mr. John Sadwith and Ms. Karen Grote

In honor of Alexander and Nicole Salmins
Inga Theeke

In honor of Mary B. Schaefer
Brandy and Daniel Bertram

In honor of Scott Ladies
Judith and Kai Petersen

In honor of Caryl Shipley
Martin and Jo Semple

In honor of Annie Slocum
Ms. JoAnne Friedman and Gracie Friedman

In honor of Jim and Sheree Sutton
Alice Gann and Jeff Parks

In honor of Mrs. Thomas E. Taplin
Newell Grant

In honor of Nancy Thomas
Ms. Liesl Thomas

In honor of Larry and Marcia Vickerman
Ms. Leslie Baldwin

In honor of Brian Vogt
Caroline Schomp

In honor of James Waring White
Dr. Andrew Sirotnak

In honor of Dr. & Mr. Caroline Wool Tinley
Celia and Ken Wool

In honor of James Waring White
Wool Family Foundation



Stay connected to the Gardens!

Use #MyDBG

botanicgardens.org

